

**SOAP DISH WITH DRAIN HOLES & SQUARE TOWEL BAR – Surface Mounted, Satin Finish**

Specialty Accessories

MasterFormat Section 10 28 13

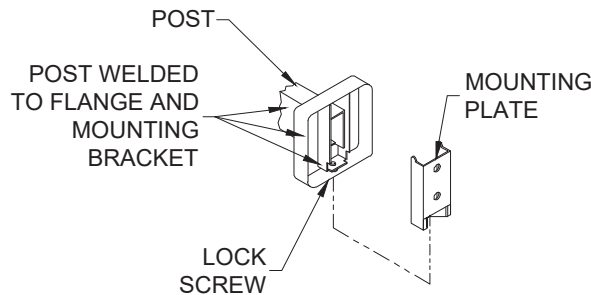
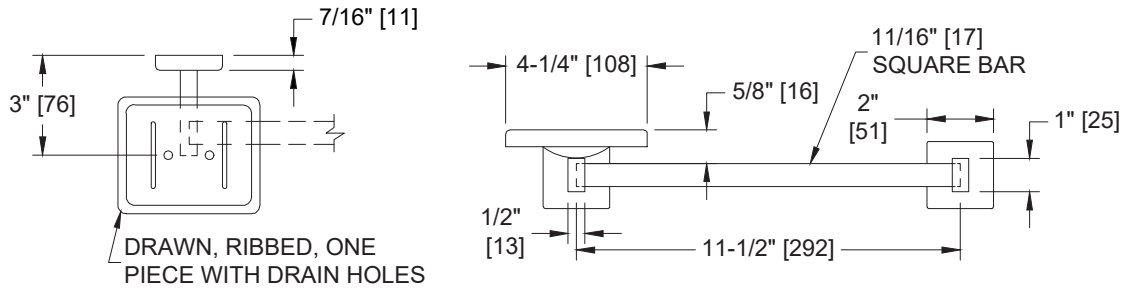

Scan for Information



**SUSTAINABILITY/LEED**

MR 4.1 (1) MR 6 (1) EQ 4.2 (1)  
MR 4.2 (1) EQ 4.1 (1) EQ 4.4 (1)

**NOTE:**  
ALL DIM'S INCH [MM]  
ILLUSTRATION FOR REF ONLY AND NTS

**PRODUCT OVERVIEW**

Soap dish has raised ribs to elevate soap slightly above dish surface to promote drying. Drain holes in bottom of dish allow excess water to drain away from soap. Towel bar is 3/4" [19] 20 gauge square tubing and is suitable for washcloths or hand towels. Satin-finish stainless steel. Model Option Notes: 7330-B – Bright finish 7330-S – Satin finish

**KEY FEATURES & SPECIFICATIONS**

- Type 304 Stainless Steel - Satin Finish
- Surface Mounted

**OPERATION & MAINTENANCE**

Soap dish has raised ribs to elevate soap slightly above dish surface to promote drying. Drain holes in bottom of dish allow excess water to drain away from soap. Towel bar is suitable for washcloths or hand towels.

**TECHNICAL INFORMATION / PRODUCT PROPERTIES**

| Property     | Value  |
|--------------|--|
| Dimensions   | 13-1/2" [343] x 2-5/4" [54] x 4-1/4" [108] D w/ 11/16" [17] Square Towel Bar |
| Construction | Type 304 Stainless Steel - Satin Finish                                      |
| Mounting     | Surface Mounted  |
| Capacity     |  |

**INSTALLATION**

Surface mount unit on wall using #10 self-threading screws (by others) through holes provided in mounting plates into suitable prepared mountings (by others) or other suitable mounting hardware (by others) to suit wall conditions. Hang post and flange assemblies on mounting plates and tighten setscrews to lock unit to plates. For compliance with ICC/ANSI A-117.1-2003 and 2010 ADA Accessibility Standards install unit with top of shelf 48" [1219] maximum Above Finished Floor (AFF) if clear floor forward reach or if clear floor side reach access only is provided or 46" [1168] max AFF if side reach access over an obstruction (e.g. vanity) with reach depth greater than 10" [254] and less than 25" [635] is only provided or 44" [1118] max AFF if forward reach over an obstruction (e.g. commode) with reach depth greater than 20" [508] and less than 25" [635] is only provided. For general utility install shelf with centerline of mounting plates at 68" [1727] AFF.

**ADDITIONAL INFORMATION**

N/A

**WARRANTY**

One (1) Year from date of Invoice